

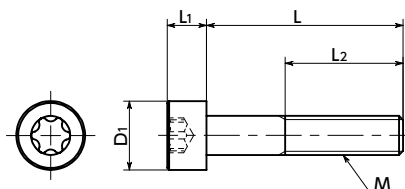

SNCX Hexalobular Socket Head Cap Screws



Material/Finish



	SNCX
Main Body	SCM435 Ferrosferric Oxide Film (Black)
Strength Class	12.9

Application

Prevention of damage to screw heads
Reliable tightening

Part Number Specification

SNCX-M5-20



- Hexalobular socket shapes*1 are designed to withstand high tightening torque compared to cross-recesses.
- Recesses are unlikely to be damaged due to tightening, allowing safe and secure tightening to be performed.
- Strength class is 12.9. High strength.
- M3 - M12. Selection from abundant size variations is available to suit the device or equipment.

*1: The hexalobular shape is prescribed by JIS B 1015: 2008(ISO 10664: 2005)"Hexalobular internal driving feature for bolts and screws".

Unit : mm

Part Number 1	M (Coarse)		L 2		D1	L1	L2*1	Hexalobular Socket No.	Mass (g)	Qty per Pack
	Nominal of Thread	Pitch								
SNCX-M3	M3	0.5	5	6 8 10 12 15 16 20	5.5	3	Full Thread	10	0.67 - 1.36	50
SNCX-M4	M4	0.7	6	8 10 12 15 16 20 25 30 35 40 45 50	7	4	20(L≥30)	25	1.5 - 5.244	50
SNCX-M5	M5	0.8	8	10 12 15 16 20 25 30 35 40 45 50	8.5	5	22(L≥30)	27	2.45 - 8.6	50
SNCX-M6	M6	1	10	12 15 16 20 25 30 35 40 45 50	10	6	24(L≥35)	30	4.7 - 12.51	50
SNCX-M8	M8	1.25	12	15 16 20 25 30 35	13	8	Full Thread	45	10.519 - 18.08	20
SNCX-M10	M10	1.5	15	16 20 25 30 35 40	16	10	Full Thread	50	19.208 - 32.604	10
SNCX-M12	M12	1.75	20	25 30 35 40 45 50	18	12	Full Thread	55	32 - 55.15	5

*1: If the "L" value is not in parentheses, the screw is full thread.

• When purchasing less volume than one full bag, a separate handling fee is charged. For details, see the Sold Separately Service.

Related Products

SKX Hexalobular Wrench



SKXB Hexalobular Short Bit



SKX-N Hexalobular Wrench for Extremely Limited Access Spaces



SRD Magnet Screwdriver



1 Individual Sales	Cleanroom Wash & Packaging	Screw Length Adjustment	Vibration Resistant	Modification process for captive use
Available / Add'l charge	Not Available	Available / Add'l charge	Available / Add'l charge	Please feel free to contact us