

● Performance

Retention Torque *1	5 N·m
Loss Torque *2	0.05 N·m
Velocity Ratio	Constant Velocity (1:1)

*1: Load torque from output side which EPL can hold.

*2: Torque lost when torque is transmitted from input side to output side

● Material/Finish



	EPL
Main Body	A6061 Anodized
Output Shaft	SUS440C (Hardness: 52 - 58 HRC)

Part Number	Mass (g)
EPL-48-D6-D6	135

⚠ Precautions for Use

Be sure to read the Instruction Manual before use to ensure safe and correct usage.

The Instruction Manual can be downloaded from the NBK website.

- Position retention (locking) optional parts used in combination with EPU-100.
- Suitable for preventing positioning misalignment due to equipment vibration, external force, or dead weight in vertical use after positioning with EPU-100.
- The input/output velocity ratio is 1:1.

● Function

The torque ① from the input side (EPU-100 side) is transmitted ② to the output side (equipment side).

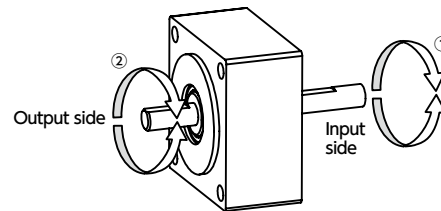

The torque load from the output side is not transmitted to the input side.

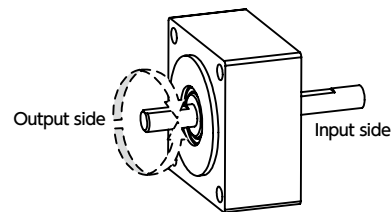

● Mounting

① Align the output shaft of the EPU-100 with the D-cut surface phase of the hole on the input side of the lock adapter EPL, and insert.

② Align the spigot joint, and combine EPL and EPU-100 in parallel.

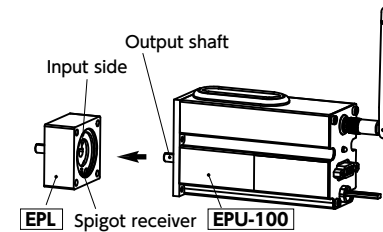

③ Insert EPL between the equipment side mounting part and EPU-100, and fix with a hex socket head cap screw such that there are no gaps between EPU-100, EPL, and the equipment.
*Hex socket head cap screws are not provided.

When fixing from equipment side

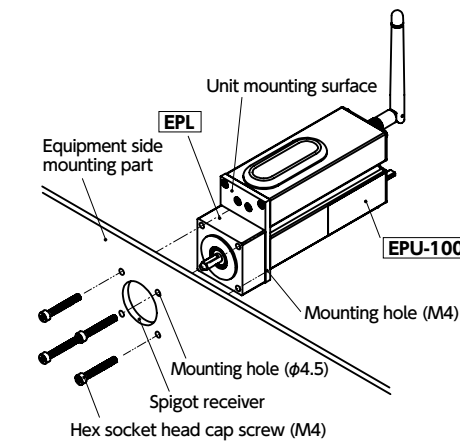

Equipment side mounting part recommended machining dimensions

When fixing from equipment side: 4-φ4.5
When fixing from EPU-100 side: 4-M3

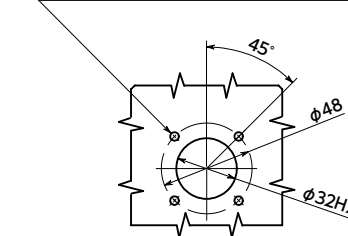

When fixing from EPU-100 side

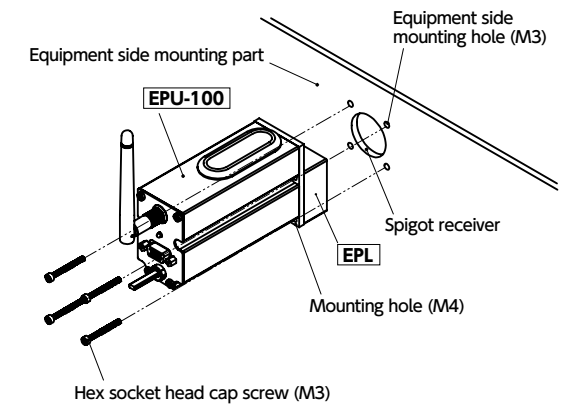

● Related Products

Hex socket head cap screws with long thread parts SNS5-FT suitable for EPL mounting are available.



● Part number specification

EPL-48-D6-D6



Available Area : Japan, the US, Canada, China