



# SNST Hex Socket Head Cap Screws - Titanium

Cleanroom wash &amp; packaging

Chemical-proof

Non-Magnetic

Lightweight

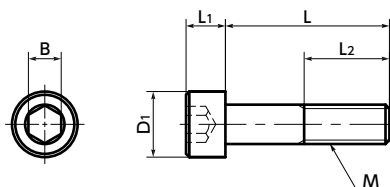

## Material/Finish



	SNST
Main Body	TW340 (Grade 2 Titanium)

## Mechanical Properties

	TW340 (Grade 2 Titanium)
Tensile Strength (N/mm <sup>2</sup> )	340 - 510
0.2% Proof Load (N/mm <sup>2</sup> )	215 or More
Elongation (%)	23 or More

• Values in chart are for reference only. They are not guaranteed values.

## Physical Properties

	TW340 (Grade 2 Titanium)
Specific Gravity	4.51
Melting Point (°C)	1668
Longitudinal Elastic Modulus (GPa)	106
Thermal Conductivity (W/(m·K))	17.16
Linear Expansion Coefficient (K <sup>-1</sup> )	$8.4 \times 10^{-6}$
Electric Resistance ( $\mu\Omega \cdot m$ )	0.55
Magnetic Permeability ( $\mu$ )	1.0001 (Nonmagnetic)

• Values in chart are for reference only. They are not guaranteed values.



- The specific gravity is approximately 60% that of stainless steel.
- Non-magnetic.
- Excellent chemical resistance / seawater resistance.
- For the properties of titanium materials, see "Properties of Titanium."
- Compliant with JIS B 1176, ISO 4762, and DIN 912.
- Special chemical polishing and brightening treatment improve the quality of the surface. Additionally, products have been cleanroom washed and packed. Cleanroom specification prevents oil and dirt from adhering.

SNST



Unprocessed



## Application

Lightweight applications in automobiles, aircrafts, spacecrafts, and robots FPD production equipment, semiconductor devices, electrical and electronic equipment, aquatic applications, and electrochemical plating

																				Unit : mm		
Part Number	M (Coarse)		L											D <sub>1</sub>	L <sub>1</sub>	B	L <sub>2</sub> *1	Tension Rupture Load *2 (N)	Torsional Torque *2 (N・m)	Mass (g)		
	Nominal of Thread	Pitch																				
SNST-M3	M3	0.5	5	6	8	10	12	16	20					5.5	3	2.5	Full Thread	3210	1.5	0.38 - 0.77		
SNST-M4	M4	0.7		6	8	10	12	16	20	25	30			7	4	3	20(L=30)	5610	3.4	0.86 - 2.1		
SNST-M5	M5	0.8				10	12	16	20	25	30	35		8.5	5	4	22(L≥30)	9080	7.1	1.5 - 3.6		
SNST-M6	M6	1				10	12	16	20	25	30	35	40	45	50	10	6	5	24(L≥35)	12800	12	2.7 - 7.5

\*1 : If the "L" value is not in parentheses, the screw is full thread.

\*2 : Values in chart are for reference only. They are not guaranteed values.

## Part Number Specification

### SNST-M5-20

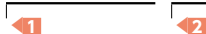

Batch cleanroom packing is provided for orders containing multiple items of the same size.

Individual Sales	Cleanroom Wash & Packaging	Screw Length Adjustment	Vibration Resistant	Modification process for captive use
1 piece in 1 pack	Cleanroom washed and packed	Available / Add'l charge	Available / Add'l charge	Available / Add'l charge