

# SPS-C Plastic Screw - Hex Socket Head Cap Screws - PPS

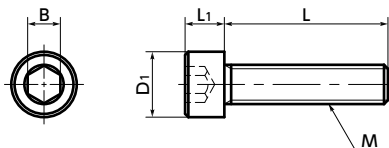

Heat-resistance Chemical-proof High Specific Strength



● Material/Finish



	<b>SPS-C</b>
Main body	PPS (Polyphenylene Sulfide) / Bright Light Brown Glass Fiber 40%
Heat Resistance Temperature*1	200°C

\*1: This is the value for the plastic material. The maximum operating temperature of the product changes with performance conditions such as tightening torque.

- PPS has excellent heat resistance and chemical resistance and continuous duty temperature of 200°C. Under 200°C, no oils, fats, or organic solvents dissolve PPS.
- It has high strength, high rigidity, and high heat resistance strength.
- It has high incombustibility that meets V-0 of UL 94.
- The properties and precautions of plastic screws  
➔ P.xxxx

● Application

FPD production equipment, semiconductor devices, printed circuit board etching devices, metallic surface treatment equipment and facilities, chemical plants, transformers, electrical and electronic equipment, hot water pumps, and chemical pumps

Unit : mm

Part Number	M (Coarse)		L	D1	L1	B	Tension*1 Rupture Load (N)	Torsional*1 Torque (N·m)	Mass (g)	Qty per pack
	Nominal of Thread	Pitch								
<b>SPS-M3-C</b>	M3	0.5	6 8 10 12 15 20	5.5	3	2.5	558	0.29	0.15 - 0.29	20
<b>SPS-M4-C</b>	M4	0.7	6 8 10 12 15 20	7	4	3	966	0.69	0.32 - 0.56	20
<b>SPS-M5-C</b>	M5	0.8	8 10 12 15 20 25 30	8.5	5	4	1548	1.23	0.52 - 1.2	10
<b>SPS-M6-C</b>	M6	1	10 12 15 20 25 30 40	10	6	5	2028	2.05	1 - 2.3	10
<b>SPS-M8-C</b>	M8	1.25	10 12 15 20 25 30 40	13	8	6	3701	5.48	2.2 - 4.4	5

\*1: Values in chart are for reference only. They are not guaranteed values. The recommendation torque is 50% of the torsional torque.  
● When purchasing less volume than one full bag, a separate handling fee is charged. For details, see the Sold Separately Service.

● Part number specification

## SPS - M5 - 20 - C



Individual Sales ➔ P.xxxx	Cleanroom Wash & Packaging ➔ P.xxxx	Screw Length Adjustment ➔ P.xxxx	Vibration Resistant ➔ P.xxxx	Modification process for captive use ➔ P.xxxx
Available / Add'l charge	Available / Add'l charge	Available / Add'l charge	Not Available	Please feel free to contact us