

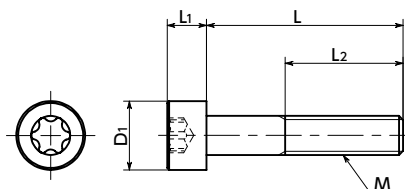

SNCXS Hexalobular Socket Head Cap Screws

SUS Stainless steel



Material/Finish



| | |
|----------------|--------------|
| | SNCXS |
| Main Body | SUSXM7 |
| Strength Class | A2-70 |

Application

Prevention of damage to screw heads
Reliable tightening

Part Number Specification

SNCXS-M5-20



- Hexalobular socket shapes*1 are designed to withstand high tightening torque compared to cross-recesses.
- Recesses are unlikely to be damaged due to tightening, allowing safe and secure tightening to be performed.
- M3 - M10. Selection from abundant size variations is available to suit the device or equipment.

*1: The hexalobular shape is prescribed by JIS B 1015: 2008(ISO 10664: 2005)"Hexalobular internal driving feature for bolts and screws".

Unit : mm

| Part Number | M (Coarse) | | L | | | | | | | | | | | | | | D1 | L1 | L2*1 | Hexalobular Socket No. | Mass (g) | Qty per Pack |
|-------------|-------------------|-------|---|---|---|----|----|----|----|----|----|----|----|----|----|-----|----|-------------|----------|------------------------|---------------|--------------|
| | Nominal of Thread | Pitch | | | | | | | | | | | | | | | | | | | | |
| SNCXS-M3 | M3 | 0.5 | 5 | 6 | 8 | 10 | 12 | 14 | 15 | 16 | 20 | | | | | 5.5 | 3 | Full Thread | 10 | 0.67 - 1.36 | 20 | |
| SNCXS-M4 | M4 | 0.7 | 5 | 6 | 8 | 10 | 12 | 14 | 15 | 16 | 20 | 25 | 30 | 35 | 40 | 7 | 4 | 20(L≥30) | 25 | 1.299 - 4.343 | 20 | |
| SNCXS-M5 | M5 | 0.8 | | 6 | 8 | 10 | 12 | 14 | 15 | 16 | 20 | 25 | 30 | 35 | | 8.5 | 5 | 22(L≥30) | 27 | 2.45 - 6.364 | 20 | |
| SNCXS-M6 | M6 | 1 | | | 8 | 10 | 12 | 14 | 15 | 16 | 20 | 25 | 30 | 35 | 40 | 50 | 10 | 6 | 24(L≥35) | 30 | 4.425 - 12.51 | 20 |
| SNCXS-M8 | M8 | 1.25 | | | | | | | 15 | 16 | 20 | 25 | 30 | 35 | 40 | 13 | 8 | 28(L=40) | 45 | 11.222 - 19.934 | 10 | |
| SNCXS-M10 | M10 | 1.5 | | | | | | | 15 | 16 | 20 | 25 | 30 | 35 | 40 | 50 | 16 | 10 | 32(L=50) | 50 | 19.208 - 39.6 | 5 |

*1: If the "L" value is not in parentheses, the screw is full thread.

• When purchasing less volume than one full bag, a separate handling fee is charged. For details, see the Sold Separately Service.

Related Products

SKX Hexalobular Wrench



SKXB Hexalobular Short Bit



SKX-N Hexalobular Wrench for Extremely Limited Access Spaces



SRD Magnet Screwdriver



| | | | | |
|---------------------------|---------------------------------------|--------------------------------|----------------------------|---|
| 1 Individual Sales | Cleanroom Wash & Packaging | Screw Length Adjustment | Vibration Resistant | Modification process for captive use |
| Available / Add'l charge | Available / Add'l charge | Available / Add'l charge | Available / Add'l charge | Available / Add'l charge |