

# SPA-LH Plastic Screws - Hexalobular Socket Head Cap Screw with Low Profile - RENY

 Protrusion
  High strength
  High Specific Strength

e-nedzi.com®

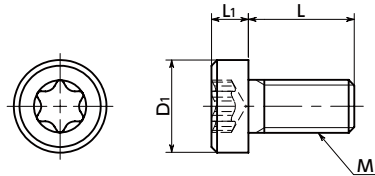

## Material/Finish



	SPA-LH
Main Body	RENY™*1 (50% Glass Fiber Reinforced Polyamide MXD6) (Black)
Heat Resistance Temperature*2	105°C

\*1: RENY™ is a trademark or registered trademark of Mitsubishi Gas Chemical Company, Inc.

\*2: This is the value for the resin material. The operating temperature of the product changes with performance conditions such as tightening torque.





- RENY™ low profile cap screw.
- RENY™ is a thermoplastic engineering plastic with excellent tensile and bending strength.
- It is highly fatigue-resistant and has excellent creep and heat insulation properties.
- While it is nearly as strong as metal, its weight is approximately 1/5 of iron.
- The recess has a hexalobular\*1 shape that can withstand high tightening torque.
- Install and remove with **SKX** Dedicated Wrench or **SKXB** Dedicated Bit and **SRD** Dedicated Magnetic Screwdriver together.
- Use the **SKX-N** hexalobular wrench for extremely limited access spaces for mounting and removing in tight spaces.
- For the properties and precautions of plastic screws, please refer to "Properties of Plastic Screws".

\*1: The hexalobular shape is prescribed by JIS B 1015: 2008(ISO 10664: 2005)"Hexalobular internal driving feature for bolts and screws".





## Application

Electrical and electronic equipment / Insulation and dew condensation prevention for refrigerators and freezers / Aquatic applications / Electrochemical plating / Lightweight applications in automobiles / Aircrafts / Spacecrafts

Unit : mm																			
Part Number	M (Coarse)		L 								D <sub>1</sub>	L <sub>1</sub>	Applicable Wrench	Hexalobular Socket No.	Tension Rupture Load*1 (N)	Torsional Torque*1 (N·m)	Mass (g)	per Pack Qty	
	Nominal of Thread 	Pitch																	
SPA-M3-LH	M3	0.5	6	8	10	12	16	20			5.5	2.4	SKX-10	10	884	0.35	0.13 - 0.25	20	
SPA-M4-LH	M4	0.7	6	8	10	12	16	20	25		7	3.1	SKX-20	20	1340	0.84	0.24 - 0.53	20	
SPA-M5-LH	M5	0.8	6	8	10	12	16	20	25	30	8.5	3.65	SKX-25	25	2102	1.38	0.42 - 1.02	20	
SPA-M6-LH	M6	1			10	12	16	20	25	30	40	10	4.4	SKX-30	30	2651	2.19	0.79 - 1.85	10

\*1: Values in chart are for reference only. They are not guaranteed values. The recommended tightening torque is 50% of the torsional torque.

• When purchasing less volume than one full bag, a separate handling fee is charged. For details, see the Sold Separately Service.

<b>1</b> Individual Sales	 Cleanroom Wash & Packaging	 Screw Length Adjustment	 Vibration Resistant	 Modification process for captive use
Available / Add'l charge	Available / Add'l charge	Not Available	Not Available	Not Available



 <https://www.nbk1560.com>

## Related Products

RENY™ hex nuts and washers **SPA-N** **SPA-W** are available.



**SKX** Hexalobular Wrench



**SKX-N** Hexalobular Wrench for Extremely Limited Access Spaces



**SKXB** Hexalobular Short Bit



**SRD** Magnet Screwdriver



## Part number specification

**SPA - M5 - 30 - LH**

Product Symbol **1** **2** Product Symbol



 <https://www.nbk1560.com>