

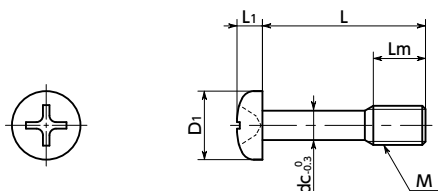

SSCPB Phillips Pan Head Captive Screws - Brass

Non-Magnetic



Material/Finish



SSCPB

Main Body

Brass *1

*1: The coloring may change over time or in response to environmental conditions, but the performance will not be affected.

Installation Example

Make a screw hole in the cover, and then pass the **SSCPB** thread part through it. Even when the screw is removed from the frame, **SSCPB** does not fall out of the cover because the **SSCPB** thread part catches on the cover screw hole.

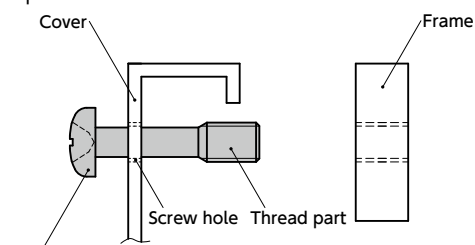

SSCPB Cross recessed pan head captive machine screw

⚠ Precautions for Use

- Screw hole inner diameter on the cover side shall be at least the dc dimension.
- The cover thickness should be 0.8 mm or above.



- Prevents fallout and loss of the screw. They are intended to fix protective and inspection covers that are frequently installed and removed.
- Non-magnetic.
- For CE Marking compatibility.
- Application

For fixing protective covers and maintenance covers
CE Marking compatible
Machine tools / Electrical and electronic equipment

Unit : mm

Part Number	M (Coarse)		L	Lm	D1	L1	dc	Cross-recessed Socket No.	Mass (g)
	Nominal of Thread	Pitch							
SSCPB-M3	M3	0.5	8 10 12 16	4	5.5	2	2.2	2	0.65 - 1
SSCPB-M4	M4	0.7	10 12 16 20	5	7	2.6	3	2	1.4 - 2.2
SSCPB-M5	M5	0.8	12 16 20 25	6	9	3.3	3.9	2	2.9 - 4.5
SSCPB-M6	M6	1	12 16 20 25 30	8	10.5	3.9	4.6	3	4.6 - 7.9
SSCPB-M8	M8	1.25	16 20 25 30 35	10	14	5.2	6.3	3	11 - 17

Part Number Specification

SSCPB-M6-12

1

2

1 Individual Sales	Cleanroom Wash & Packaging	Screw Length Adjustment	Vibration Resistant	Modification process for captive use with Captive Processing
1 piece in 1 pack	Available / Add'l charge	Not Available	Not Available	